

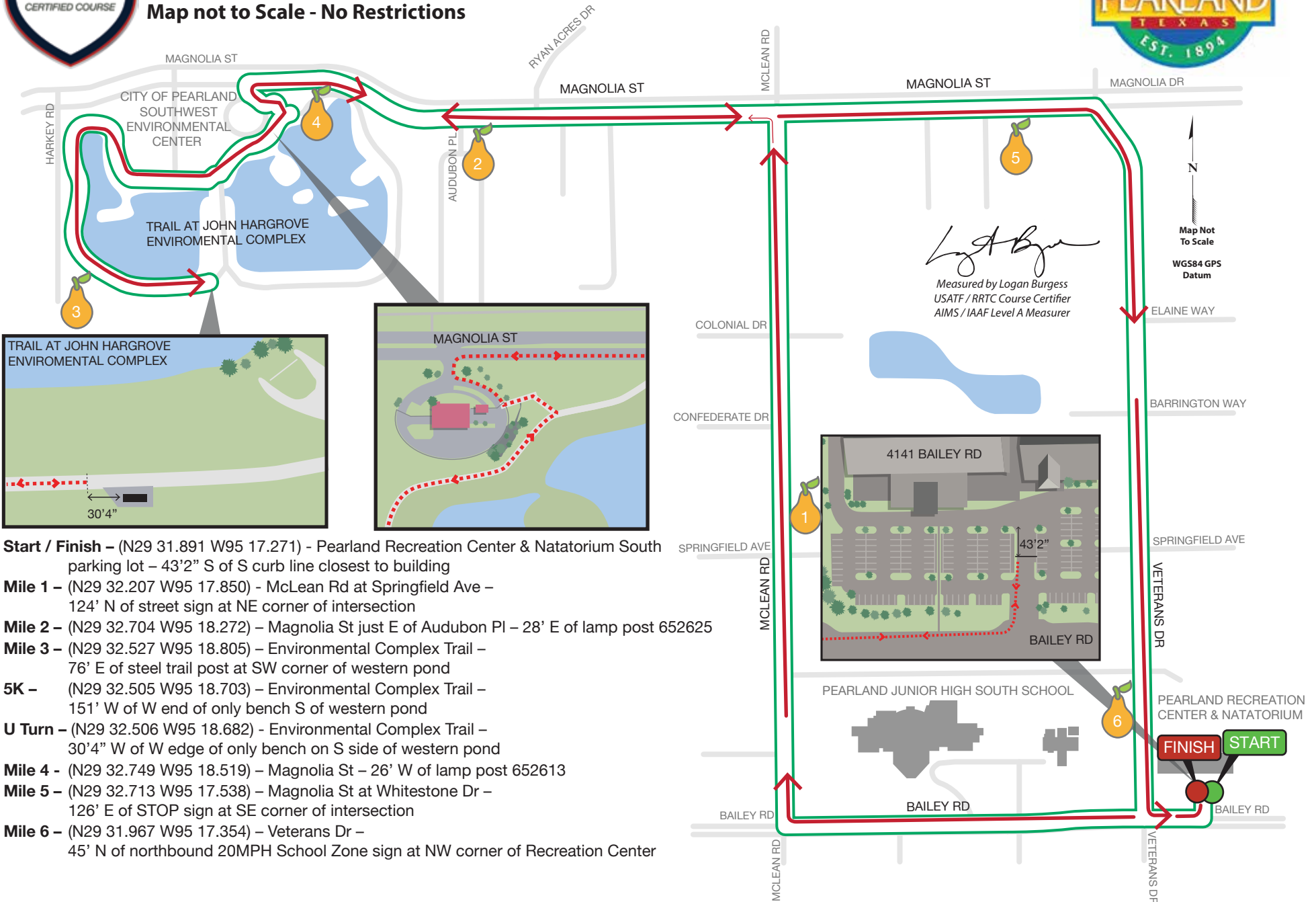

Pearland RCN 10K
10 km - USATF Certification TX18075LAB - Pearland, TX
Effective June 13, 2018 to December 31, 2028
Measured by Logan Burgess on June 1, 2018
Map not to Scale - No Restrictions



Start / Finish – (N29 31.891 W95 17.271) - Pearland Recreation Center & Natatorium South parking lot – 43'2" S of S curb line closest to building

- Mile 1** – (N29 32.207 W95 17.850) - McLean Rd at Springfield Ave – 124' N of street sign at NE corner of intersection
- Mile 2** – (N29 32.704 W95 18.272) – Magnolia St just E of Audubon Pl – 28' E of lamp post 652625
- Mile 3** – (N29 32.527 W95 18.805) – Environmental Complex Trail – 76' E of steel trail post at SW corner of western pond
- 5K** – (N29 32.505 W95 18.703) – Environmental Complex Trail – 151' W of W end of only bench S of western pond
- U Turn** – (N29 32.506 W95 18.682) - Environmental Complex Trail – 30'4" W of W edge of only bench on S side of western pond
- Mile 4** – (N29 32.749 W95 18.519) – Magnolia St – 26' W of lamp post 652613
- Mile 5** – (N29 32.713 W95 17.538) – Magnolia St at Whitestone Dr – 126' E of STOP sign at SE corner of intersection
- Mile 6** – (N29 31.967 W95 17.354) – Veterans Dr – 45' N of northbound 20MPH School Zone sign at NW corner of Recreation Center



Road Running Technical Council
USA Track & Field

Measurement Certificate



Name of the course Pearland RCN 10K Distance 10 km

Location (state) TX (city) Pearland

Type of course: road race calibration course

Measuring method: bicycle steel tape electronic distance meter

Measured by (name, address, phone & e-mail) Logan A Burgess - loganaburgess@yahoo.com

614 Stillmeadow Dr, Richardson, TX 75081 - 214.803.7800

Race contact (name, address, phone & e-mail) Pearland Parks & Recreation - www.pearlandparks.com

4141 Bailey Rd, Pearland, TX 77584 - 281.412.8900

Date(s) when course measured: June 1, 2018

Number of measurements of entire course: 2 Course Configuration: Keyhole

Elevation (meters above sea level) Start 21 m Finish 21 m Highest 22 m Lowest 17 m

Straight line distance between start & finish 0 Drop 0 m/km Separation 0 %

Type of surface: paved 100 % dirt 0 % gravel 0 % grass 0 % track 0 %

Effective date of certification: June 13, 2018 Certification code: TX18075LAB

Notice to Race Director: Use this Certification Code in **all** public announcements relating to your race.

Be It Officially Noted That

Based on examination of data provided by the above named measurer, the course described above and in the map attached is hereby certified as reasonably accurate in measurement according to the standards adopted by the Road Running Technical Council. If **any** changes are made to the course, this certification becomes void, and the course must then be recertified.

Verification of Course — In the event a National Open Record is set on this course, or at the discretion of USA Track & Field, a verification remeasurement may be required to be performed by a member of the Road Running Technical Council. If such a remeasurement shows the course to be short, then all pending records will be rejected and the course certification will be cancelled.

This certification expires on December 31 in the year 2028

AS NATIONALLY CERTIFIED BY:

Date: June 13, 2018

Logan Burgess – USATF/RRTC Certifier

614 Stillmeadow Drive, Richardson, TX 75081 - loganaburgess@yahoo.com - 214.803.7800